

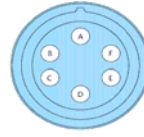

# MATING CONNECTORS

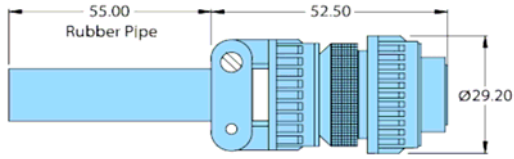

6 Pin - MS style mating-half & Pin information

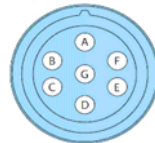
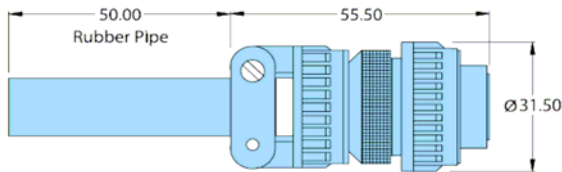

7 Pin - MS style mating-half & Pin information

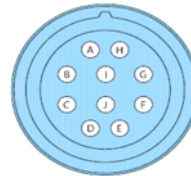
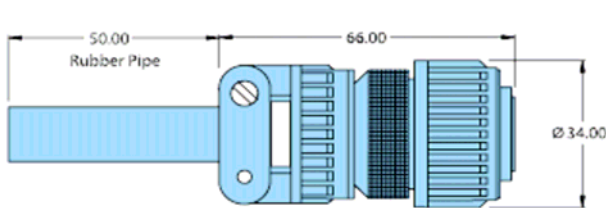

10 Pin - MS style mating-half & Pin information

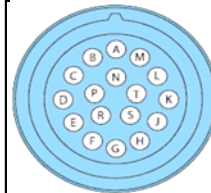
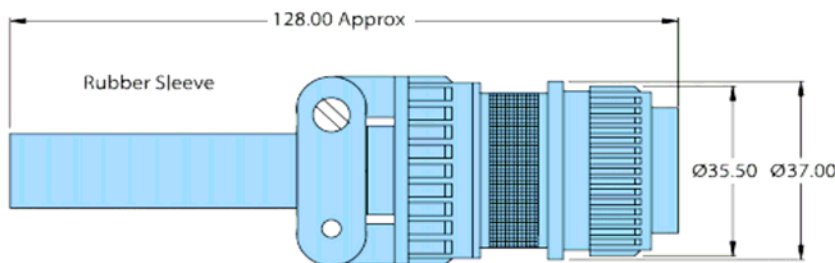

17 Pin - MS style mating-half & Pin information

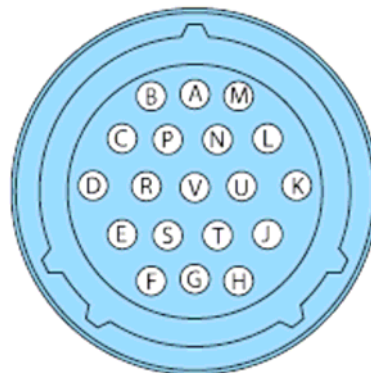
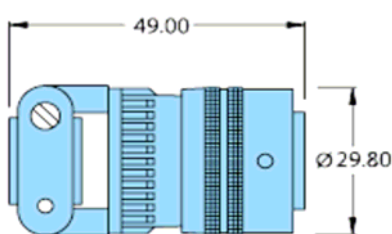

19 Pin - MS style mating-half & Pin information

TEL: (UK) +44 (0) 1978 664722  
FAX: (UK) +44 1978 664733  
WEB: [www.industrialencodersdirect.co.uk](http://www.industrialencodersdirect.co.uk)  
EMAIL: [sales@industrialencodersdirect.co.uk](mailto:sales@industrialencodersdirect.co.uk)

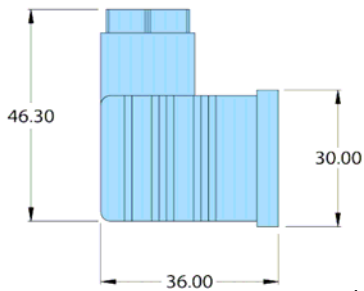

*4 Pin Hirschmann style mating-half & Pin information*

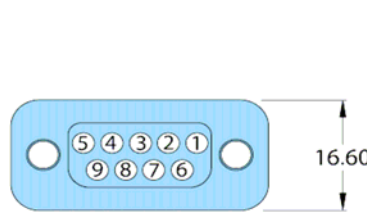
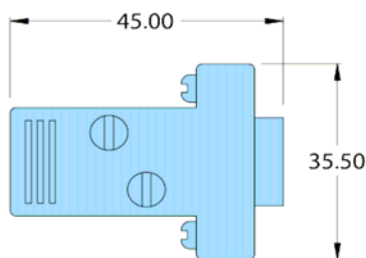

*9 Pin D-Type style mating-half & Pin information*

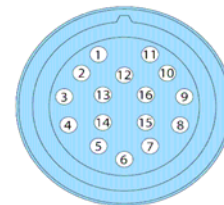
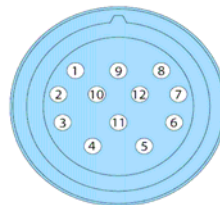
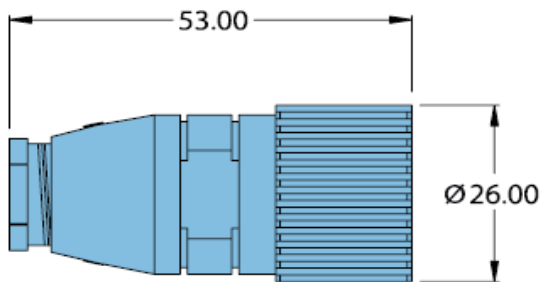

*12 Pin & 16 Pin - Contact style mating-half & Pin information*

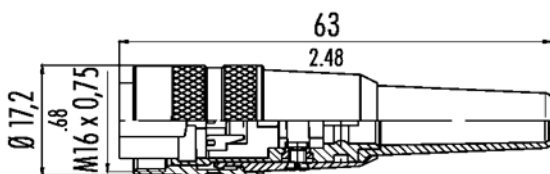

*Amphenol / Binder style mating-half available in 5 Pin, 8 Pin & 12 Pin*

*Pin connections vary model to model to match various international encoder manufacturer, and model type standards. Please call technical department for more information.*

*Many other connector types and termination methods are available on request.*

TEL: (UK) +44 (0) 1978 664722

FAX: (UK) +44 1978 664733

WEB: [www.industrialencodersdirect.co.uk](http://www.industrialencodersdirect.co.uk)

EMAIL: [sales@industrialencodersdirect.co.uk](mailto:sales@industrialencodersdirect.co.uk)