

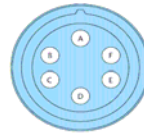

MATING CONNECTORS

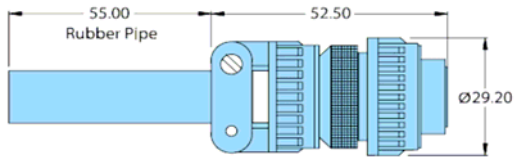

6 Pin - MS style mating-half & Pin information

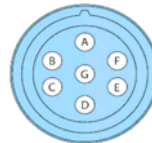
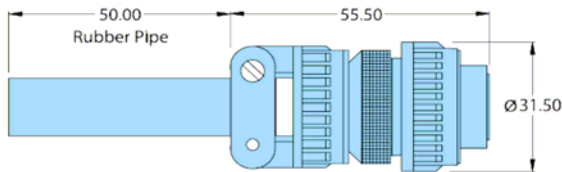

7 Pin - MS style mating-half & Pin information

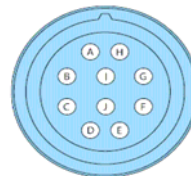
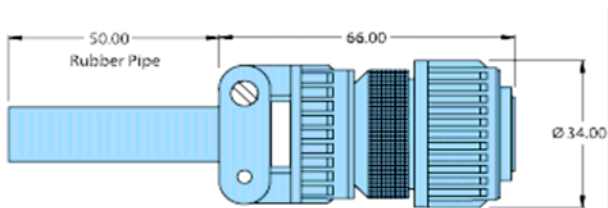

10 Pin - MS style mating-half & Pin information

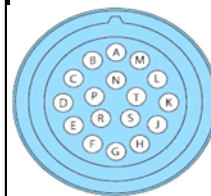
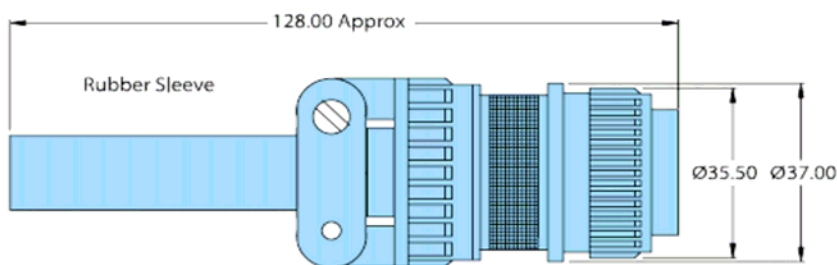

17 Pin - MS style mating-half & Pin information

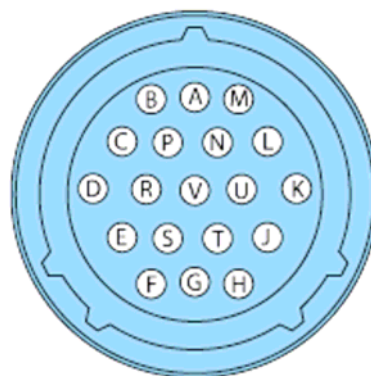
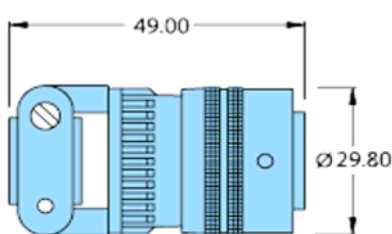

19 Pin - MS style mating-half & Pin information

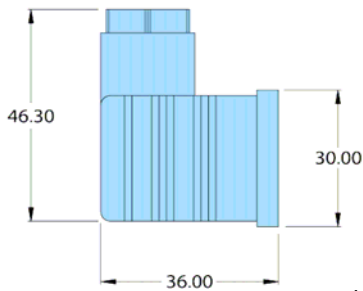

4 Pin Hirschmann style mating-half & Pin information

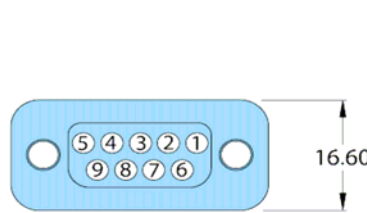
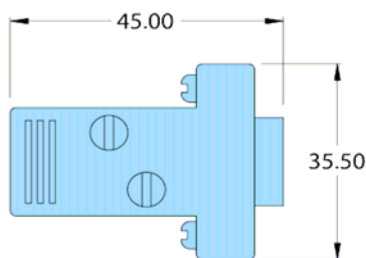

9 Pin D-Type style mating-half & Pin information

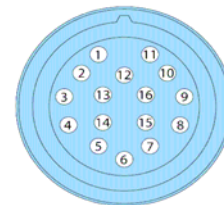
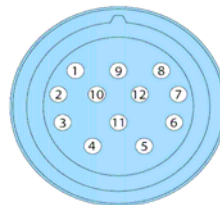
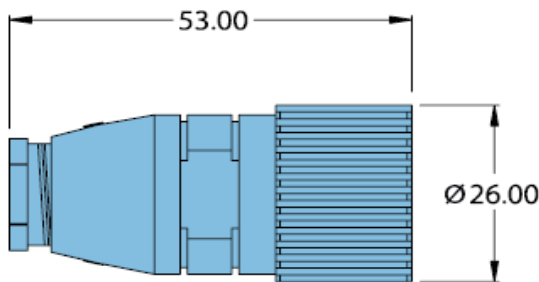

12 Pin & 16 Pin - Contact style mating-half & Pin information

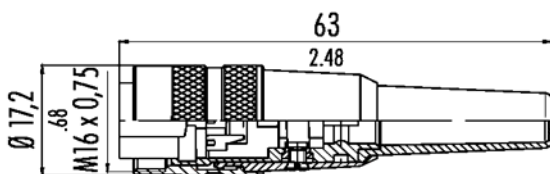

Amphenol / Binder style mating-half available in 5 Pin, 8 Pin & 12 Pin

Pin connections vary model to model to match various international encoder manufacturer, and model type standards. Please call technical department for more information.

Many other connector types and termination methods are available on request.

TEL: (UK) +44 (0) 1978 664722

FAX: (UK) +44 1978 664733

WEB: www.industrialencodersdirect.co.uk

EMAIL: sales@industrialencodersdirect.co.uk